

Model CC-550 CULTIVATOR

ASSEMBLY □ OPERATION □ MAINTENANCE □ PARTS LIST

INTRODUCTION

The cultivator and its accessories may be used to cultivate a wide range of garden vegetables or field crops. They can be set up for straddle-row and/or between-row cultivation.

ASSEMBLY

FIG. 1. Attach hitch bracket (1) to pull bar (2) using the two $7/16'' \times 1\frac{1}{4}''$ plow bolts (3), lock washers (4), and square nuts (5). *Finger tighten only.*

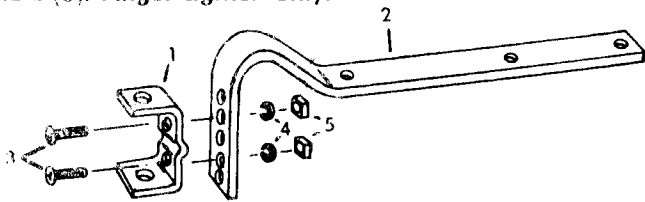

FIG. 2. Attach tie bar (6) and the two frame angles (7) to the pull bar (2) as shown, using three $\frac{1}{2}'' \times 1\frac{1}{2}''$ hex bolts (8), lock washers (9), and hex nuts (10).

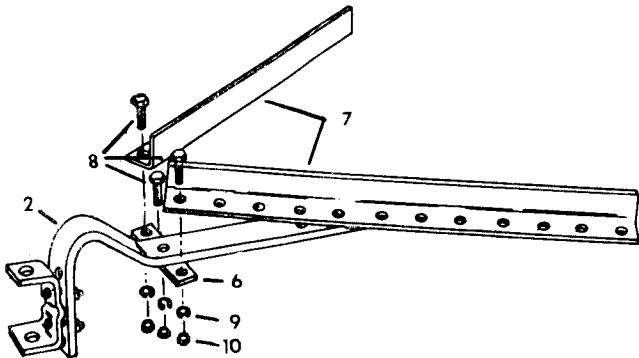

FIG. 3. Assemble tie straps (11) to pull bar with a $\frac{1}{2}'' \times 2''$ hex bolt (12), lock washer (13), and hex nut (14). Align the tie bars with appropriate holes on each of the frame angles. **Note:** *The holes used should be selected to create the desired width of cultivation. The forwardmost holes provide the widest path of cultivation, and the rearmost holes the narrowest.* Secure the tie bars to the frame angles with $\frac{1}{2}'' \times 1\frac{1}{2}''$ hex bolts (15), lock washers (16), and hex nuts (17).

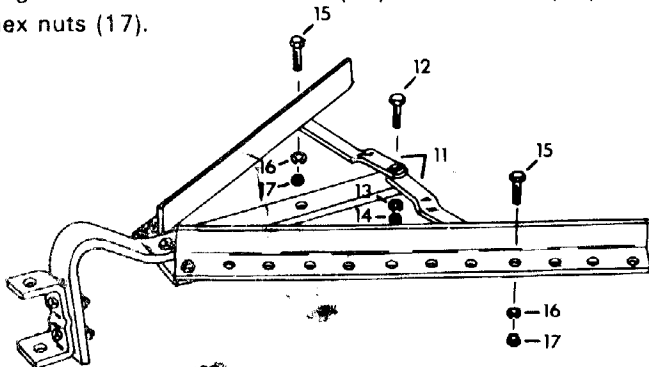
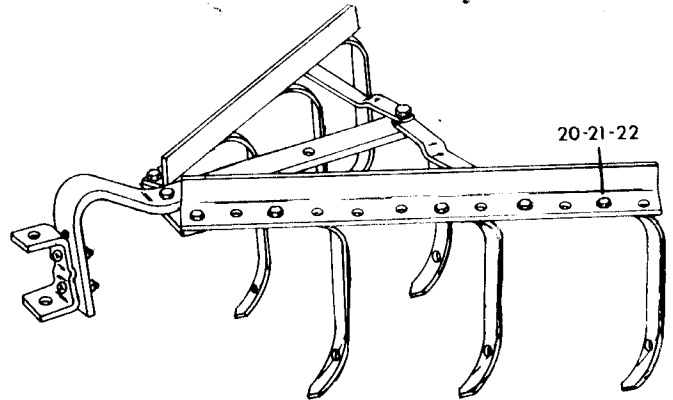
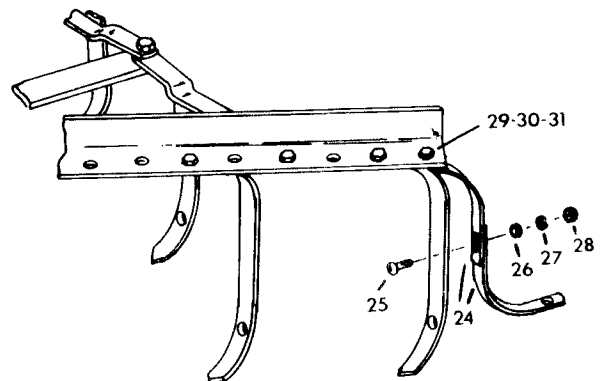

FIG. 4. Assemble six rigid shanks to the frame angles, securing with $\frac{1}{2}'' \times 1\frac{1}{2}''$ hex bolts (20), lock washers (21), and hex nuts (22).



When assembling for in-between row cultivation, the extra shank must be mounted to the center of the cultivator, using the same hole and bolt used to fasten tie bars to pull bar, as shown. Set all shanks to run straight in the direction of travel.

FIG. 5. Assemble the gauge shoe halves (24) using two $\frac{3}{8}'' \times 1''$ carriage bolts (25), plain washers (26), lock washers (27), and hex nuts (28). Attach to frame angles as shown, using $\frac{1}{2}'' \times 1\frac{1}{2}''$ hex bolts (29), lock washers (30), and hex nuts (31).



MOUNTING ADJUSTMENT

Attach Cultivator to your tractor hitch with hitch in lowered position. Adjust hitch bracket on cultivator to obtain desired depth of cultivator. Cultivator should be parallel to ground. Pull bar may be inverted to increase depth of cultivation. Adjust gauge shoes to maintain desired depth. Tighten all bolts securely.

OPERATION

Cultivate at a slow tractor speed. Additional weight is not normally required for cultivating light soil. However, it is necessary when soil is heavy, crusted, and/or thickly weeded, in order to improve the cultivator's penetration and stability. A concrete block should be attached to the center of the pull bar with the 3/8" x 9-1/2" rod tie-down, plain washer, lock washer, and hex nut furnished.

MAINTENANCE

The cultivator is maintenance-free. However, as with any steel product, it can rust. For rust on gauge shoes and shanks, apply a light coat of oil. For rust on mounting bracket and frame parts, sand and apply a light coat of enamel paint.

REF. NO.	PART NO.	DESCRIPTION
2.	C-362	Hitch bracket
3.	C-363	Pull bar
4.	C-364	Frame angle
5.	C-365	Frame tie bar
6.	C-366	Rigid shank
7.	C-367	Gauge shoe half
8.	C-368	Rod tie-down
9.	C-369	Tie strap
10.	1M1624P	Hex bolt 1/2" x 1 1/2"
11.	1M1632P	Hex bolt 1/2" x 2"
12.	11M1216P	Carriage bolt 3/8" x 1"
13.	15M1428P	Plow bolt 7/16" x 1 3/4"
14.	30M1200P	Hex nut 3/8"
15.	30M1600P	Hex nut 1/2"
16.	35M1400P	Square nut 7/16"
17.	40M1200P	Lock washer 3/8"
18.	40M1400P	Lock washer 7/16"
19.	40M1600P	Lock washer 1/2"
20.	45M1313P	Plain washer 3/8"

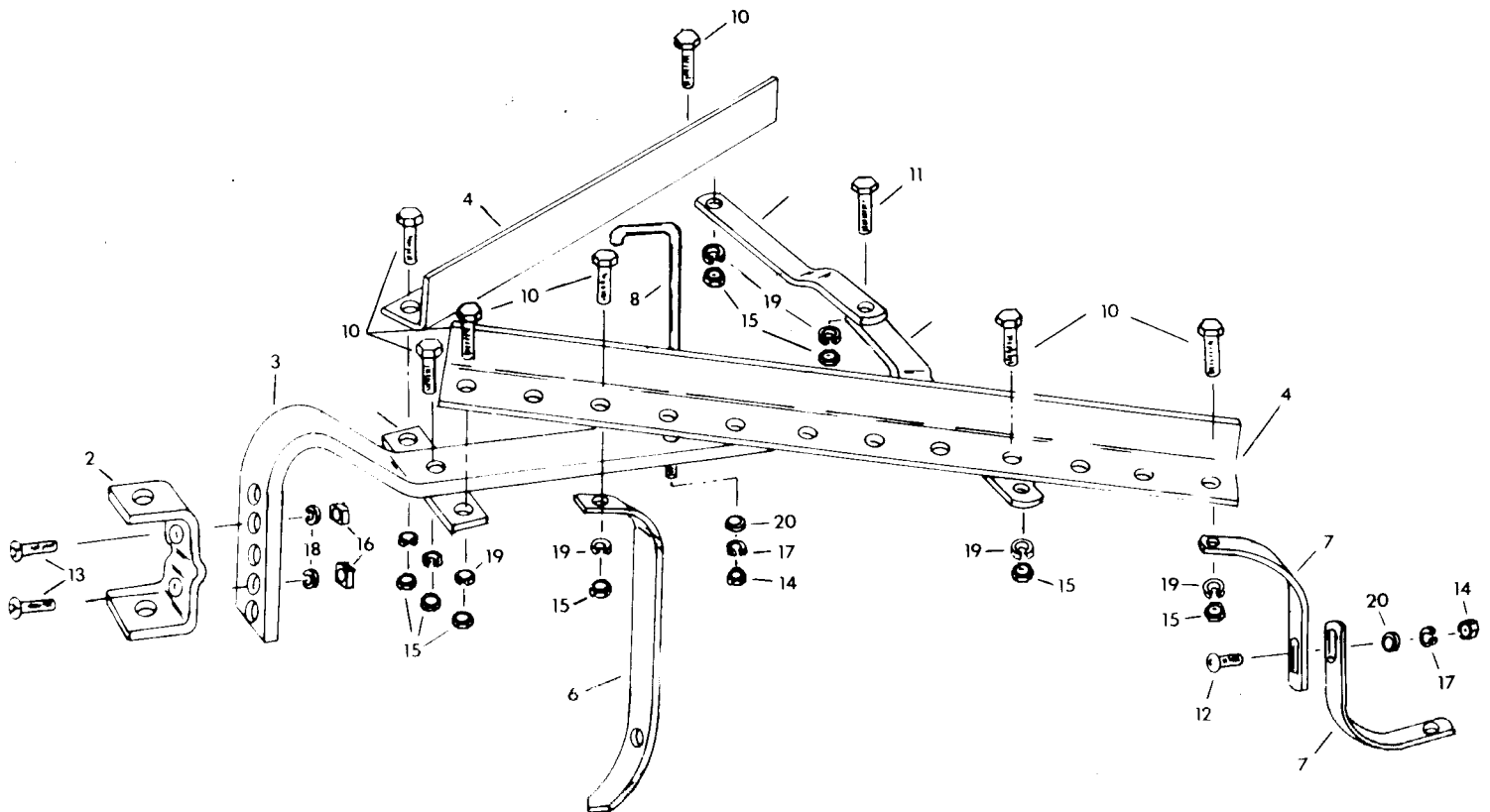

LIMITED WARRANTY

We warrant each Brinly Product sold by us to be free from manufacturing defects in normal service for a period of one (1) year (90 days for commercial or rental application) commencing with the delivery to the original retail user.

Our obligation under this warranty is expressly limited, at our option, to the replacement or repair at Brinly-Hardy Company, (340 E. Main Street, Louisville, Ky. 40202) of such part or parts as inspection shall disclose to have been defective. This warranty does not apply to defects caused by damage or unreasonable use (including failure to provide reasonable and necessary maintenance) while in the possession of the consumer.

WE SHALL NOT BE LIABLE FOR CONSEQUENTIAL DAMAGES OF ANY KIND, including but not limited to, consequential labor costs or transportation charges in connection with the replacement or repair of defective parts.

ANY IMPLIED OR STATUTORY WARRANTIES, INCLUDING ANY WARRANTY OF MERCHANTABILITY OR FITNESS FOR A PARTICULAR PURPOSE, ARE EXPRESSLY LIMITED TO THE DURATION OF THIS WRITTEN WARRANTY. We make no other express warranty, nor is anyone authorized to make any in our behalf.

For parts and service, see your local dealer. Use part NAME and NUMBER when ordering.

BRINLY-HARDY COMPANY (502) 585-3351 P.O. Box 1116, Louisville, Ky. 40201